

MEGASTAR

OWNER'S MANUAL & ASSEMBLY INSTRUCTIONS



P107 SMITH MACHINE



Installation Video

WEBSITE:

megastarfitness.com

EMAIL:

support@megastarfitness.com

FOLLOW US ON SOCIAL MEDIA

for the latest
updates and
exclusive
deals!

 @megastar.fitness

 @Megastar Fitness

 @MEGASTARFIT

 @megastar.fitness

P107 SMITH MACHINE WARRANTY

1.PREPARATION

Ensure you have all the necessary tools and components before starting the assembly. A complete parts list is included in this manual. In the event should you find this product has either a defective or a missing part, do not use substitute parts or try to use the unit in an incomplete form. Please contact MEGASTAR for a replacement.

2.INSTALLATION PRECAUTIONS

Assemble the P107 Smith Machine on a flat, stable surface. Avoid soft or uneven flooring to prevent instability. Do not tighten bolts and nuts fully until all components are aligned correctly. Follow the step-by-step instructions carefully. Double-check all connections and ensure bolts, nuts, and washers are securely fastened. The user of this product shall not exceed 330lbs
BEFORE BEGINNING ANY EXERCISE PROGRAM, CONSULT YOUR PHYSICIAN.

3.ROUTINE MAINTENANCE

Inspect the Smith Machine monthly for any loose bolts, nuts, or other hardware. Tighten as necessary. Lubricate moving parts as needed (depends on use but once a month is a good rule to follow). Clean the frame with a damp cloth and mild detergent. Avoid using abrasive cleaners or solvents.

4.PLACEMENT THE BENCH

If relocation is needed, disassemble larger sections to prevent structural stress. Ensure all bolts are securely tightened after reassembly.
Environmental Protection
Store the Smith Machine in a dry environment to prevent rust or corrosion.
Use rubber floor mats underneath the rack to minimize wear on both the frame and the floor.

5.WARRANTY INFORMATION

The Smith Machine frame is built to last. However, damages caused by natural disasters, accidents, improper use, or modifications are not covered under this warranty. Small components such as bolts, nuts, and washers are covered for 12 months from the date of purchase. To make a replacement, please provide proof of purchase and contact our customer service team. Replacement parts will be shipped free of charge within the warranty period.

P107 SMITH MACHINE WARRANTY

6.EXCLUSIONS

This warranty does not cover normal wear and tear, cosmetic damages, or damages resulting from misuse or negligence.

Assembly errors that lead to structural instability or damages are not covered.

7.DISCLAIMER

We are not responsible for injuries or damages resulting from failure to follow the assembly instructions or maintenance guidelines.

8.CUSTOMER SUPPORT

MEGASTAR is a professional home gym equipment manufacturer and Amazon seller. We are committed to providing efficient and customer-satisfied after-sale service for you.

If you have any questions about P107 Smith Machine, you can contact us first, and we will provide the best solution for you

we provide the accessories replacement service, shipping label service, Install Q&A service. etc Our after-sale email support@megastarfitness.com

P107 SMITH MACHINE WARRANTY

1. WHAT'S COVERED UNDER MEGASTAR LLC'S BASIC WARRANTY?

Basic Warranty.

2. WHO IS COVERED?

You are covered by the Basic Warranty if you are a purchaser of the MEGASTAR Power Cage.

3. WHAT'S COVERED?

The Basic Warranty covers the cost of all parts and labor needed to repair any item on your power cage when it left the manufacturing plant that is defective in material, workmanship or factory preparation. These warranty repairs or adjustments will be made by MEGASTAR at no charge, using new or remanufactured parts.

4. WHEN IT BEGINS?

The Basic Warranty begins from the date of order.

5. WHEN IT ENDS?

The Basic Warranty lasts for 24 months from the date it begins, but the following items are covered only for 12 months: bolts, nuts, washers, foot covers, J-hooks and plate storage pegs.

6. WHAT'S NOT COVERED?

Please note that while the standard Basic Warranty applies to defects in material and/or workmanship, it does not cover the power cage's matte finish appearance. Maintaining the matte finish appearance is solely the responsibility of the owner. Basic Warranty doesn't cover damage caused by environmental factors such as airborne fallout, insect damage, chemicals, salt, and ocean spray. Nor does your warranty cover damage caused by hailstorms, windstorms, tornadoes, sandstorms, lightning, floods, and earthquakes. Your warranty does not cover conditions resulting from anything impacting the power cage.

7. HOW TO CONTACT US?

To ensure you receive the best technical support, please visit our website:

www.megastarfitness.com and register your warranty. Customers with registered warranties are given a profile that allows for easier support and for us to contact you with important product notifications. If any parts are missing, worn, damaged or broken before the assembly, or you ever need to replace the parts, please contact us at support@megastarfitness.com.

P107 SMITH MACHINE WARRANTY

Thank you for selecting the MEGASTAR P107 Smith Machine.

The Megastar P107 Smith Machine is thoughtfully designed and crafted to enhance your workout experience, prioritizing user convenience, performance, and exceptional customer support.

For your benefit, read this manual carefully before using the P107 Smith Machine.

If you have additional questions, please contact MEGASTAR Customer Service Department at support@megastarfitness.com. To help us assist you, please note the product model number and serial number before calling. The model number is P107.

BEFORE READING FURTHER, PLEASE REVIEW THE DRAWING BELOW AND FAMILIARIZE YOURSELF WITH THE PARTS THAT ARE LABELED.

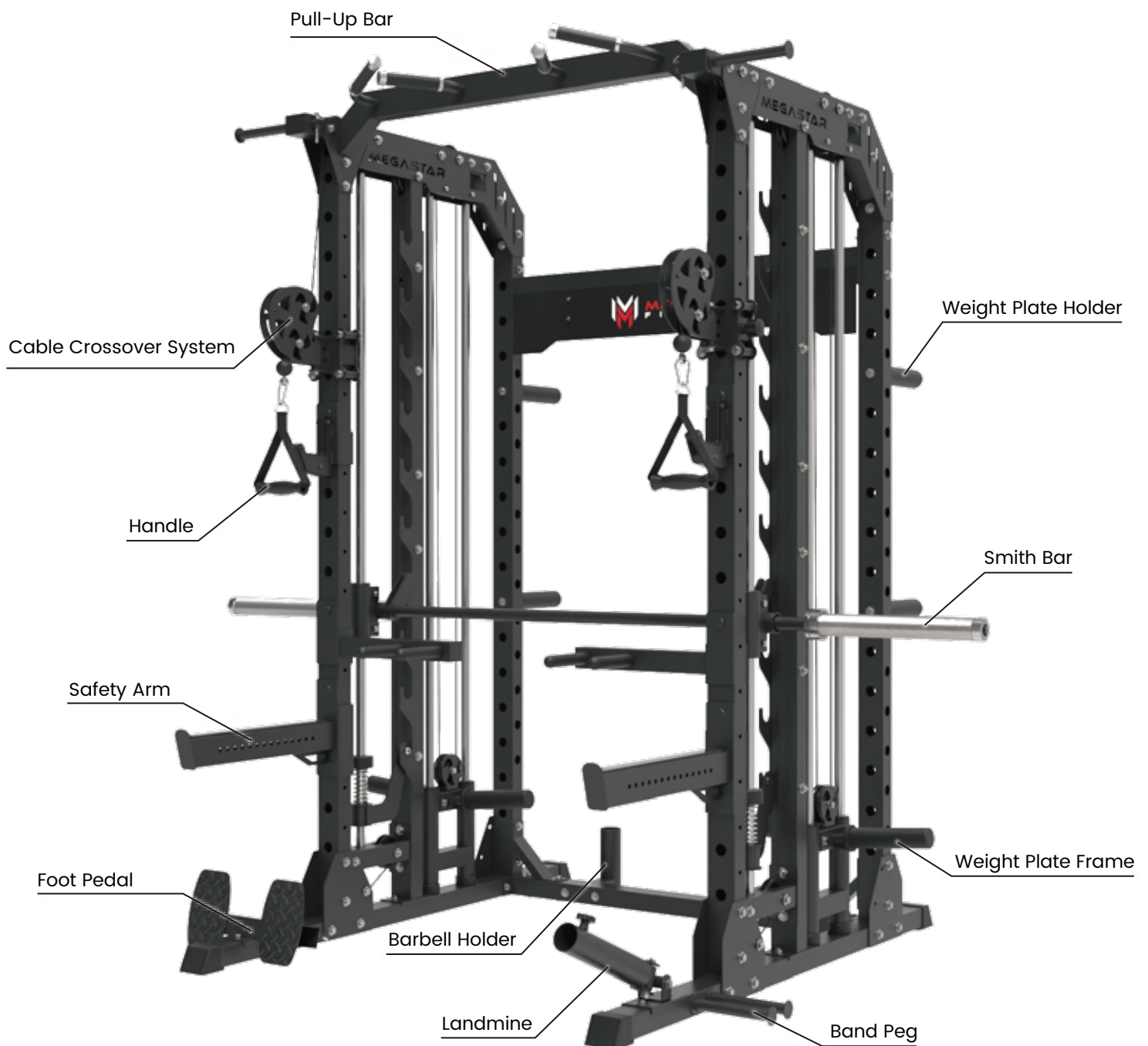

PARTS LIST

NO.	DESCRIPTION	QUANTITY
1	Bottom Base Frame	2
2	Bottom Fixed Rod	2
3	Bottom Cross Frame	1
4	Band Peg	6
5	Bottom Fixed Plate	6
6	Barbell Hold	2
7	Big Foot Pedal	1
8	Connect Plate	4
9	M5*10 Hex Bolt	8
10	M8*20 Hex Bolt	8
11	M10*20 Hex Bolt	12
12	M10*60 Hex Bolt	2
13	M10*70 Hex Bolt	20
14	M10*90 Hex Bolt	54
15	Nut	78
16	Washer	210



① Bottom Base Frame
2×



② Bottom Fixed Rod
2×



③ Bottom Cross Frame
1×



④ Band Peg
6×



⑤ Bottom Fixed Plate
6×



⑥ Barbell Hold
2×



⑦ Big Foot Pedal
1×



⑧ Connect Plate
4×



⑨ M5*10 Hex Bolt
8×

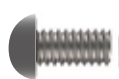

⑩ M8*20 Hex Bolt
8×

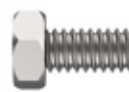

⑪ M10*20 Hex Bolt
12×



⑫ M10*60 Hex Bolt
2×



⑬ M10*70 Hex Bolt
22×



⑭ M10*90 Hex Bolt
54×



⑮ Nut
78×



⑯ Washer
210×

PARTS LIST

NO.	DESCRIPTION	QUANTITY
17	Cable Pulley	2
18	Pulley Sliding Sleeve	2
19	Guide Fixed Frame	2
20	Handle	2
21	Landmine	1
22	Guide Rod Sliding Sleeve	2
23	Logo Board L	2
24	Logo Board R	2
25	Cable	2
26	Rear Logo Connect	2
27	Shock Pad	6
28	Guide Rod	4
29	Dip Bar	2
30	Weight Plate Frame	2
31	Middle Upright Frame	2
32	Pulley	8



(17) Cable Pulley
2x



(18) Pulley Sliding Sleeve
2x



(19) Guide Fixed Frame
2x



(20) Handle
2x



(21) Landmine
1x



(22) Guide Rod Sliding Sleeve
2x



(23) Logo Board L
2x



(24) Logo Board R
2x



(25) Cable
2x



(26) Rear Logo Connect
2x



(27) Shock Pad
6x



(28) Guide Rod
4x



(29) Dip Bar
2x



(30) Weight Plate Frame
2x



(31) Middle Upright Frame
2x



(32) Pulley
10x

PARTS LIST

NO.	DESCRIPTION	QUANTITY
33	Pull-Up Bar	1
34	Rear Cross Beam	1
35	Sandwich J Cup	2
36	Safety Arm	2
37	Rear Logo	1
38	Rear Upright Frame	2
39	Small Pulley	2
40	Smith Bar	1
41	Smith Holder Plate	4
42	Smith Solid Guide Rod	2
43	Spring	2
44	Support Plate	2
45	Smith Support Rod	2
46	Plug	6
47	Upper Connect Rod	2
48	Top Fixed Plate	2



③③ Pull-Up Bar
1×



③④ Rear Cross Beam
1×



③⑤ Sandwich J Cup
2×



③⑥ Safety Arm
2×



③⑦ Rear Logo
1×



③⑧ Rear Upright Frame
2×



③⑨ Small Pulley
2×



④① Smith Bar
1×



④① Smith Holder Plate
4×



④② Smith Solid Guide Rod
2×



④③ Spring
2×



④④ Support Plate
2×



④⑤ Smith Support Rod
2×



④⑥ Plug
6×



④⑦ Upper Connect Rod
2×



④⑧ Top Fixed Plate
2×

PARTS LIST

NO.	DESCRIPTION	QUANTITY
49	Upper Cross Frame	2
50	Upright Frame	2
51	Weight Plate Holder	4
52	Clip	6
53	Weight Plate Rod	4
54	Carabiner	4
55	V Bar	1
56	Cable Bar	1
57	Lat Pull Down Bar	1



④⑨ Upper Cross Frame
2×



⑤⑩ Upright Frame
2×



⑤① Weight Plate Holder
4×



⑤② Clip
6×



⑤③ Weight Plate Rod
4×



⑤④ Carabiner
4×



⑤⑤ V Bar
1×



⑤⑥ Cable Bar
1×



⑤⑦ Lat Pull Down Bar
1×

ASSEMBLY AND ADJUSTMENT

STEP 1

NO.	DESCRIPTION	QUANTITY
1	Bottom Base Frame	2
3	Bottom Cross Frame	2
5	Bottom Fixed Plate	2
14	M10*90 Hex Bolt	4
15	Nut	4
16	Washer	8

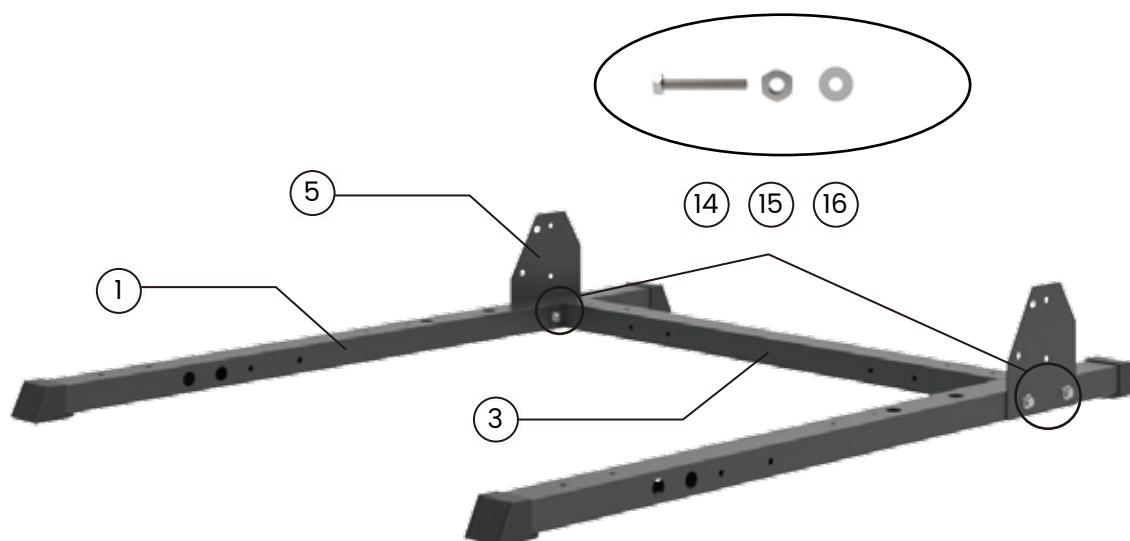

ASSEMBLY AND ADJUSTMENT

STEP 2

NO.	DESCRIPTION	QUANTITY
2	Bottom Fixed Rod	2
13	M10*70 Hex Bolt	4
14	M10*90 Hex Bolt	4
15	Nut	8
16	Washer	16
38	Rear Upright Frame	2



ASSEMBLY AND ADJUSTMENT

STEP 3

NO.	DESCRIPTION	QUANTITY
1	Bottom Fixed Rod	1
13	M10*70 Hex Bolt	8
14	M10*90 Hex Bolt	12
15	Nut	20
16	Washer	40
32	Pulley	2
41	Smith Holder Plate	4
45	Smith Support Rod	2

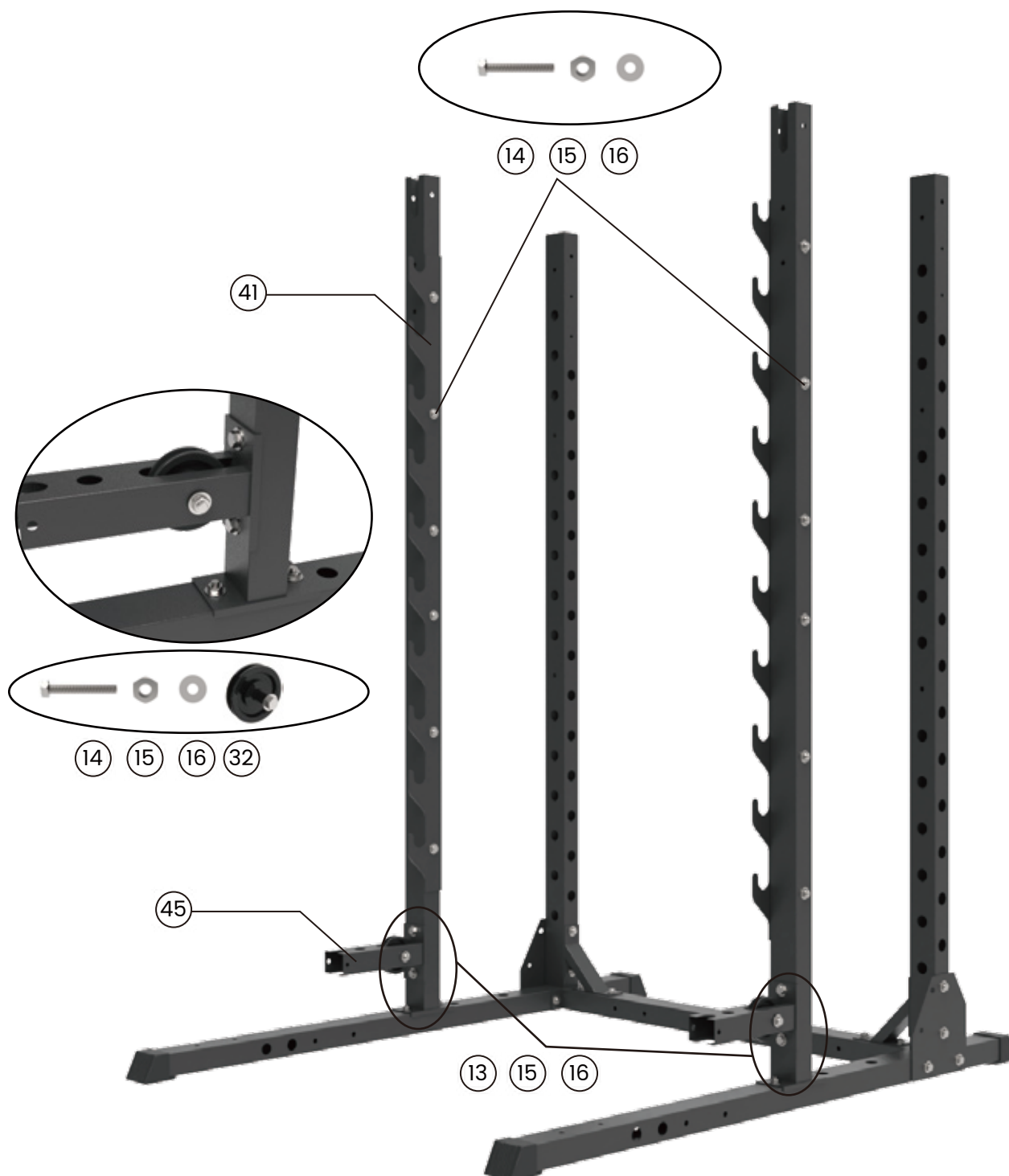

ASSEMBLY AND ADJUSTMENT

STEP 4

NO.	DESCRIPTION	QUANTITY
5	Bottom Fixed Plate	4
14	M10*90 Hex Bolt	8
15	Nut	8
16	Washer	20
17	Cable Pulley	2
18	Pulley Sliding Sleeve	2
32	Pulley	2
50	Upright Frame	2

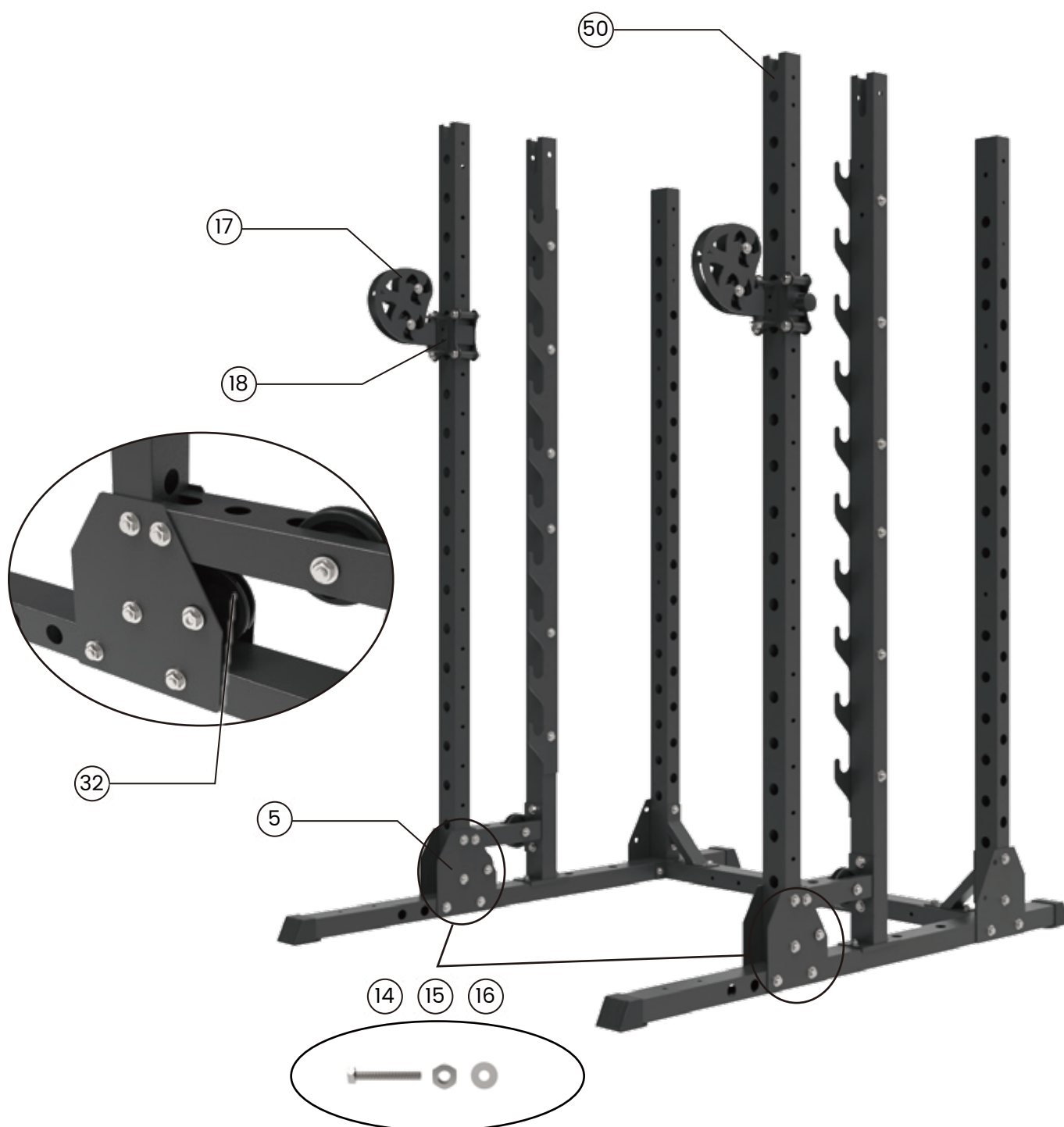

ASSEMBLY AND ADJUSTMENT

STEP 5

NO.	DESCRIPTION	QUANTITY
13	M10*70 Hex Bolt	4
15	Nut	4
16	Washer	8
47	Upper Connect Rod	2
49	Upper Cross Frame	2



ASSEMBLY AND ADJUSTMENT

STEP 6

NO.	DESCRIPTION	QUANTITY
11	M10*20 Hex Bolt	4
12	M10*60 Hex Bolt	2
15	Nut	4
16	Washer	10
22	Guide Rod Sliding Sleeve	2
27	Shock Pad	2
40	Smith Bar	1
42	Smith Solid Guide Rod	2
43	Spring	2
44	Support Plate	2



ASSEMBLY AND ADJUSTMENT

STEP 7

NO.	DESCRIPTION	QUANTITY
13	M10*70 Hex Bolt	4
15	Nut	4
16	Washer	8
19	Guide Fixed Frame	2
27	Shock Pad	4
28	Guide Rod	4
30	Weight Plate Frame	2
53	Weight Plate Rod	4

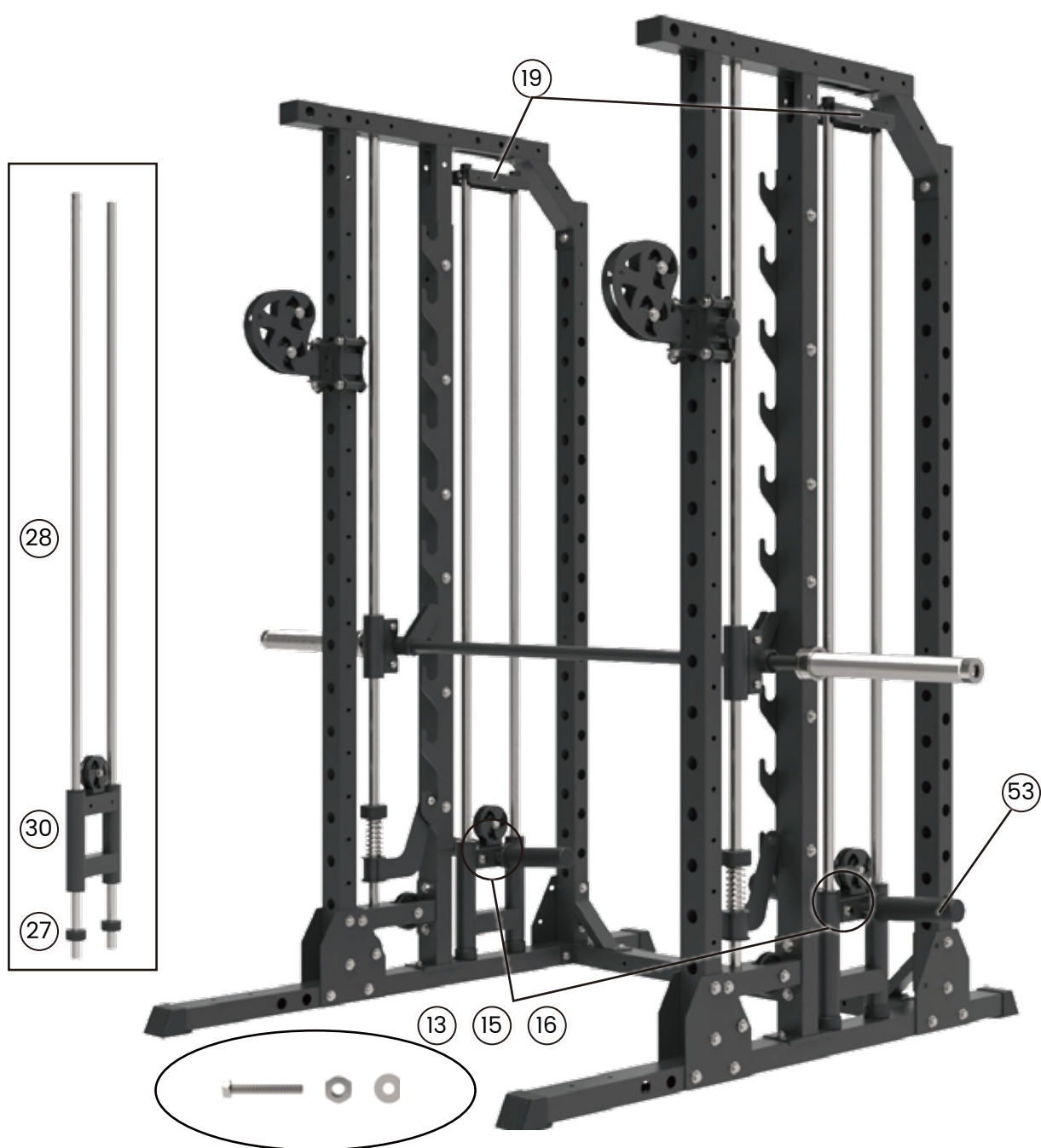

ASSEMBLY AND ADJUSTMENT

STEP 8

NO.	DESCRIPTION	QUANTITY
8	Connect Plate	4
10	M8*20 Hex Bolt	8
14	M10*90 Hex Bolt	10
15	Nut	10
16	Washer	20
23	Logo Board L	2
24	Logo Board R	2
32	Pulley	4
39	Small Pulley	2

Please install this screw
after installing the cable.

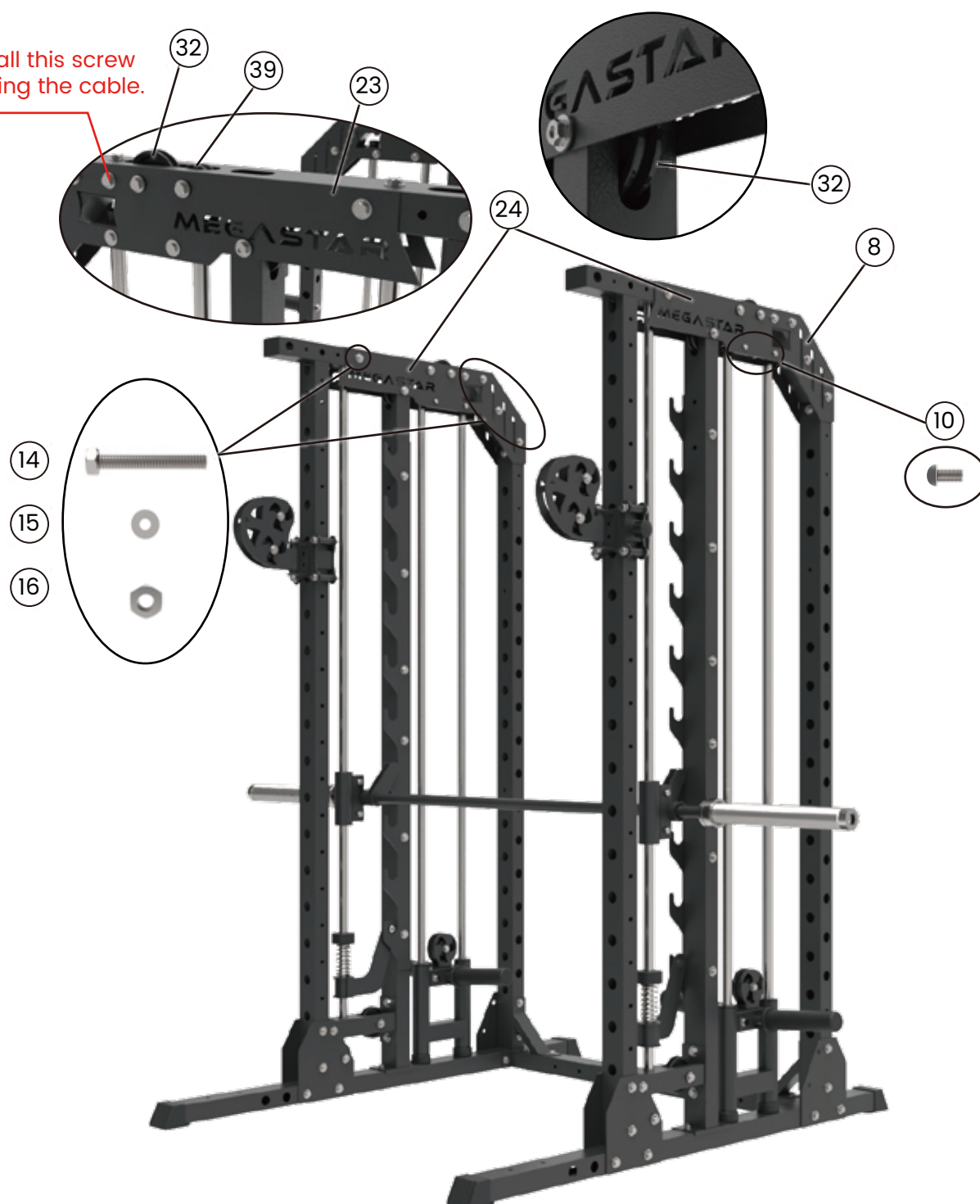

ASSEMBLY AND ADJUSTMENT

STEP 9

NO.	DESCRIPTION	QUANTITY
14	10*90 Hex Bolt	8
15	Nut	8
16	Washer	16
32	Pulley	2
33	Pull-Up Bar	1
48	Top Fixed Plate	2

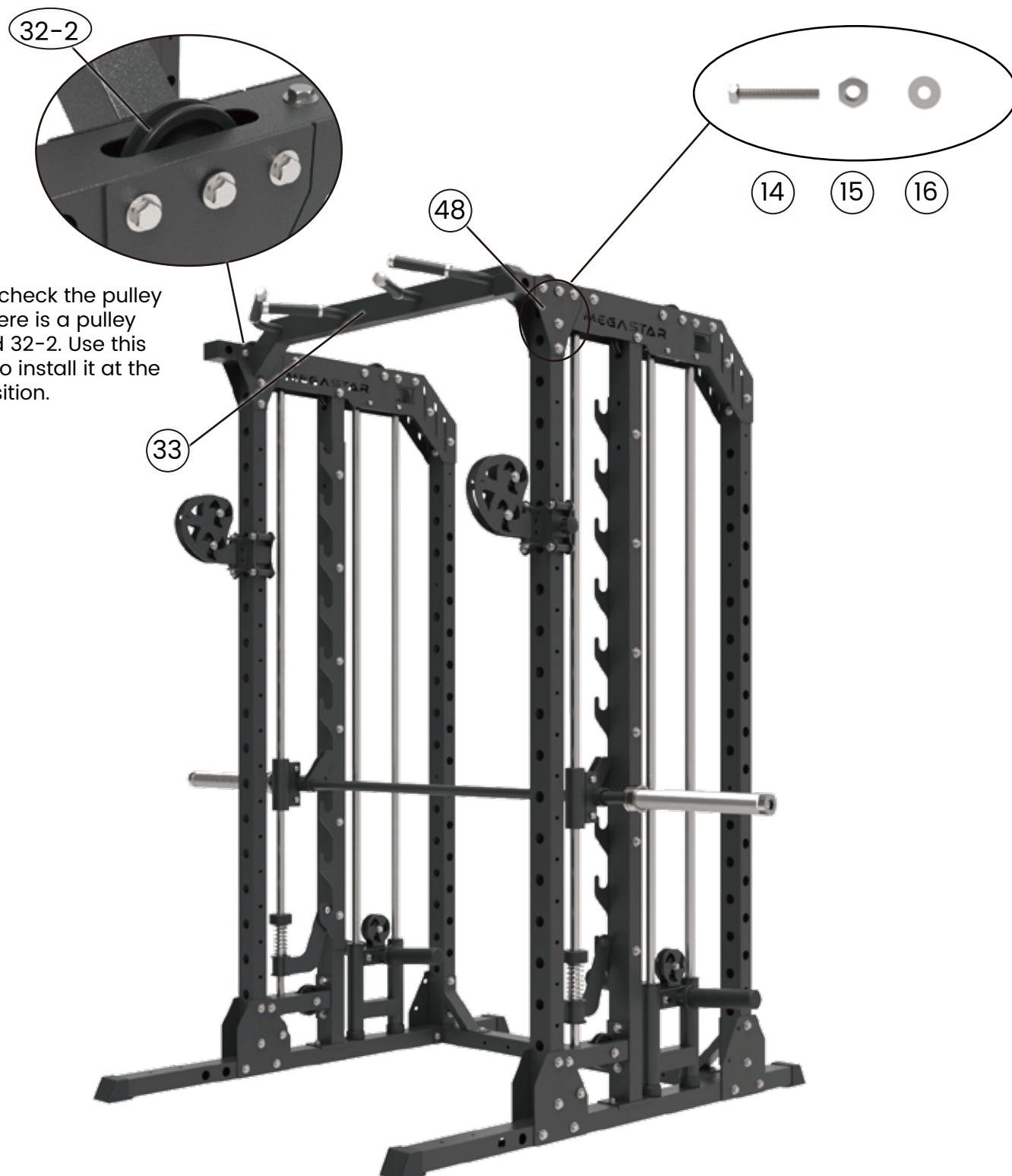

ASSEMBLY AND ADJUSTMENT

STEP 10

NO.	DESCRIPTION	QUANTITY
9	M5*10 Hex Bolt	8
14	M10*90 Hex Bolt	4
15	Nut	4
16	Washer	8
26	Rear Logo Connect	2
34	Rear Cross Beam	1
37	Rear Logo	1



ASSEMBLY AND ADJUSTMENT

STEP 11

NO.	DESCRIPTION	QUANTITY
6	Barbell Hold	2
11	M10*20 Hex Bolt	4
14	M10*90 Hex Bolt	4
15	Nut	4
16	Washer	12
51	Weight Plate Holder	4



ASSEMBLY AND ADJUSTMENT

STEP 12

NO.	DESCRIPTION	QUANTITY
4	Band Peg	6
7	Big Foot Pedal	1
11	M10*20 Hex Bolt	4
21	Landmine	1
46	Plug	4



ASSEMBLY AND ADJUSTMENT

STEP 13

NO.	DESCRIPTION	QUANTITY
29	Dip Bar	2
35	Sandwich J Cup	2
36	Safety Arm	2



ASSEMBLY AND ADJUSTMENT

STEP 14

NO.	DESCRIPTION	QUANTITY
20	Handle	2
25	Cable	2
54	Carabiner	4



ASSEMBLY AND ADJUSTMENT

