

MEGASTAR

- P63 POWER RACK -



OWNER'S MANUAL & ASSEMBLY INSTRUCTIONS

P63 POWER RACK WARRANTY

1.PREPARATION

Ensure you have all the necessary tools and components before starting the assembly. A complete parts list is included in this manual.

In the event should you find this product has either a defective or a missing part, do not use substitute parts or try to use the unit in an incomplete form. Please contact MEGASTAR for a replacement.

2.INSTALLATION PRECAUTIONS

Assemble the P63 Power Rack on a flat, stable surface. Avoid soft or uneven flooring to prevent instability.

Do not tighten bolts and nuts fully until all components are aligned correctly.

Follow the step-by-step instructions carefully.

Double-check all connections and ensure bolts, nuts, and washers are securely fastened.

The user of this product shall not exceed 330lbs

BEFORE BEGINNING ANY EXERCISE PROGRAM, CONSULT YOUR PHYSICIAN.

3.ROUTINE MAINTENANCE

Inspect the Power Rack monthly for any loose bolts, nuts, or other hardware. Tighten as necessary.

Lubricate moving parts as needed (depends on use but once a month is a good rule to follow).

Clean the frame with a damp cloth and mild detergent. Avoid using abrasive cleaners or solvents.

4.PLACEMENT THE BENCH

If relocation is needed, disassemble larger sections to prevent structural stress. Ensure all bolts are securely tightened after reassembly.

Environmental Protection

Store the Power Rack in a dry environment to prevent rust or corrosion.

Use rubber floor mats underneath the rack to minimize wear on both the frame and the floor.

5.WARRANTY INFORMATION

The Power Rack frame is built to last. However, damages caused by natural disasters, accidents, improper use, or modifications are not covered under this warranty.

Small components such as bolts, nuts, and washers are covered for 12 months from the date of purchase.

To make a replacement, please provide proof of purchase and contact our customer service team.

Replacement parts will be shipped free of charge within the warranty period.

P63 POWER RACK WARRANTY

6.EXCLUSIONS

This warranty does not cover normal wear and tear, cosmetic damages, or damages resulting from misuse or negligence.

Assembly errors that lead to structural instability or damages are not covered.

7.DISCLAIMER

We are not responsible for injuries or damages resulting from failure to follow the assembly instructions or maintenance guidelines.

8.CUSTOMER SUPPORT

MEGASTAR is a professional home gym equipment manufacturer and Amazon seller. We are committed to providing efficient and customer-satisfied after-sale service for you.

If you have any questions about P63 Power Rack, you can contact us first, and we will provide the best solution for you

we provide the accessories replacement service, shipping label service, Install Q&A service. etc Our after-sale email support@megastarfitness.com

P63 POWER RACK WARRANTY

1. WHAT'S COVERED UNDER MEGASTAR LLC'S BASIC WARRANTY?

Basic Warranty.

2. WHO IS COVERED?

You are covered by the Basic Warranty if you are a purchaser of the MEGASTAR Power Cage.

3. WHAT'S COVERED?

The Basic Warranty covers the cost of all parts and labor needed to repair any item on your power cage when it left the manufacturing plant that is defective in material, workmanship or factory preparation. These warranty repairs or adjustments will be made by MEGASTAR at no charge, using new or remanufactured parts.

4. WHEN IT BEGINS?

The Basic Warranty begins from the date of order.

5. WHEN IT ENDS?

The Basic Warranty lasts for 24 months from the date it begins, but the following items are covered only for 12 months: bolts, nuts, washers, foot covers, J-hooks and plate storage pegs.

6. WHAT'S NOT COVERED?

Please note that while the standard Basic Warranty applies to defects in material and/or workmanship, it does not cover the power cage's matte finish appearance. Maintaining the matte finish appearance is solely the responsibility of the owner. Basic Warranty doesn't cover damage caused by environmental factors such as airborne fallout, insect damage, chemicals, salt, and ocean spray. Nor does your warranty cover damage caused by hailstorms, windstorms, tornadoes, sandstorms, lightning, floods, and earthquakes. Your warranty does not cover conditions resulting from anything impacting the power cage.

7. HOW TO CONTACT US?

To ensure you receive the best technical support, please visit our website: www.megastarfitness.com and register your warranty. Customers with registered warranties are given a profile that allows for easier support and for us to contact you with important product notifications. If any parts are missing, worn, damaged or broken before the assembly, or you ever need to replace the parts, please contact us at support@megastarfitness.com.

P63 POWER RACK WARRANTY

Thank you for selecting the MEGASTAR P63 Power Rack.

The Megastar P63 Power Rack is thoughtfully designed and crafted to enhance your workout experience, prioritizing user convenience, performance, and exceptional customer support.

For your benefit, read this manual carefully before using the P63 Power Rack.

If you have additional questions, please contact MEGASTAR Customer Service Department at support@megastarfitness.com. To help us assist you, please note the product model number and serial number before calling. The model number is P63.

BEFORE READING FURTHER, PLEASE REVIEW THE DRAWING BELOW AND FAMILIARIZE YOURSELF WITH THE PARTS THAT ARE LABELED.



PARTS LIST

NO.	DESCRIPTION.	QYANTITY
1	Bottom Base Frame	2
2	Bottom Fixed Rod	2
3	Bottom Cross Frame	1
4	Band Peg	6
5	Bottom Fixed Plate	6
6	Barbell Hold	2
7	Big Foot Pedal	1
8	Connect Plate	4
9	M5*10 Hex Bolt	8
10	M8*20 Hex Bolt	8
11	M10*20 Hex Bolt	6
12	Clip	6
13	M10*70 Hex Bolt	12
14	M10*90 Hex Bolt	44
15	Nut	58
16	Washer	170
17	Cable Pulley	2



① Bottom Base Frame
2x



② Bottom Fixed Rod
2x



③ Bottom Cross Frame
1x



④ Band Peg
6x



⑤ Bottom Fixed Plate
6x



⑥ Barbell Hold
2x



⑦ Big Foot Pedal
1x



⑧ Connect Plate
4x



⑨ M5*10 Hex Bolt
8x



⑩ M8*20 Hex Bolt
8x



⑪ M10*20 Hex Bolt
6x



⑫ Clip
6x



⑬ M10*70 Hex Bolt
20x



⑭ M10*90 Hex Bolt
44x



⑮ Nut
82x



⑯ Washer
170x



⑰ Cable Pulley
2x

PARTS LIST

NO.	DESCRIPTION.	QYANTITY
18	Pulley Sliding Sleeve	2
19	Guide Fixed Frame	2
20	Handle	2
21	Landmine	1
22	Guide Rod Sliding Sleeve	2
23	Logo Board L	2
24	Logo Board R	2
25	Cable	2
26	Rear Logo Connect	2
27	Shock Pad	4
28	Guide Rod	4
29	Dip Bar	2
30	Weight Plate Frame	2
31	Late Bar	1
32	Pulley	8
33	Pull-Up Bar	1



⑱ Pulley Sliding Sleeve
2×



⑲ Guide Fixed Frame
2×



⑳ Handle
2×



㉑ Landmine
1×



㉒ Olympic Bar Handle
1×



㉓ Logo Board L
2×



㉔ Logo Board R
2×

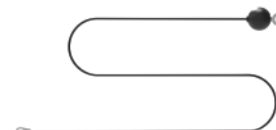

㉕ Cable
2×



㉖ Rear Logo Connect
2×



㉗ Shock Pad
4×



㉘ Guide Rod
4×



㉙ Dip Bar
2×



㉚ Weight Plate Frame
2×



㉛ Late Bar
1×



㉜ Pulley
8×



㉝ Pull-Up Bar
1×

PARTS LIST

NO.	DESCRIPTION.	QYANTITY
34	Rear Cross Beam	1
35	Sandwich J Cup	2
36	Safety Arm	2
37	Rear Logo	1
38	Rear Upright Frame	2
39	Small Pulley	2
40	Cable Bar	1
41	Upright Frame	2
42	Weight Plate Holder	4
43	Weight Plate Rod	4
44	Carabiner	4
45	Upper Cross Frame	2
46	Plug	6
47	Upper Connect Rod	2
48	Top Fixed Plate	2



③④ Rear Cross Beam
1×



③⑤ Sandwich J Cup
2×



③⑥ Safety Arm
2×



③⑦ Rear Logo
1×



③⑧ Rear Upright Frame
2×



③⑨ Small Pulley
2×



④⑩ Cable Bar
1×



④① Upright Frame
2×



④② Weight Plate Holder
4×



④③ Weight Plate Rod
4×



④④ Carabiner
4×



④⑤ Upper Cross Frame
2×



④⑥ Plug
6×



④⑦ Upper Connect Rod
2×



④⑧ Top Fixed Plate
2×

ASSEMBLY AND ANJUSTMENT

STEP 1

NO.	DESCRIPTION.	QYANTITY
1	Bottom Base Frame	2
3	Bottom Cross Frame	2
5	Bottom Fixed Plate	2
14	M10*90 Hex Bolt	4
15	Nut	4
16	Washer	8

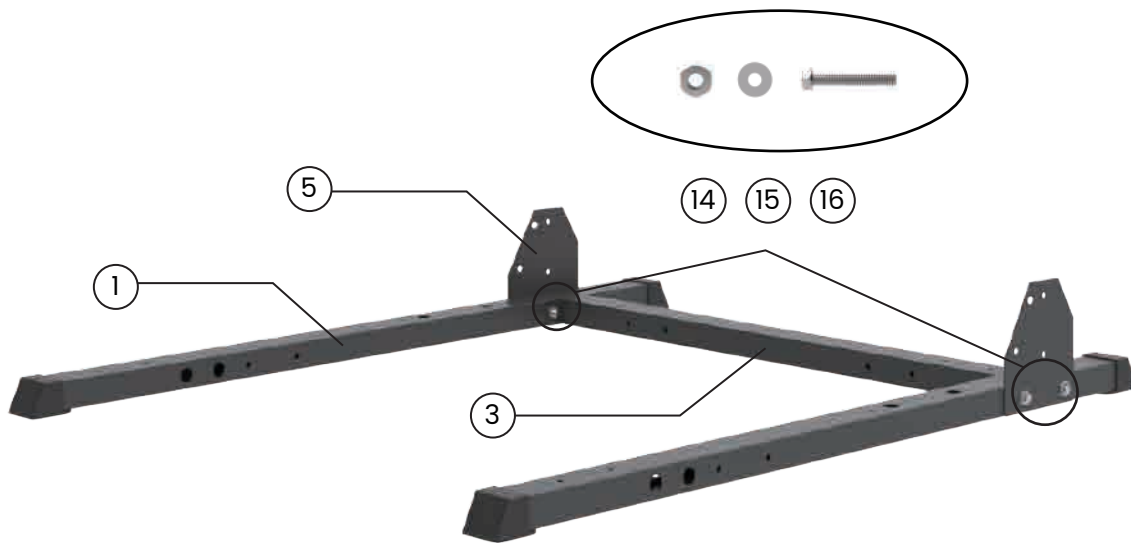

ASSEMBLY AND ANJUSTMENT

STEP 2

NO.	DESCRIPTION.	QYANTITY
2	Bottom Fixed Rod	2
13	M10*70 Hex Bolt	4
14	M10*90 Hex Bolt	4
15	Nut	8
16	Washer	16
38	Rear Upright Frame	2

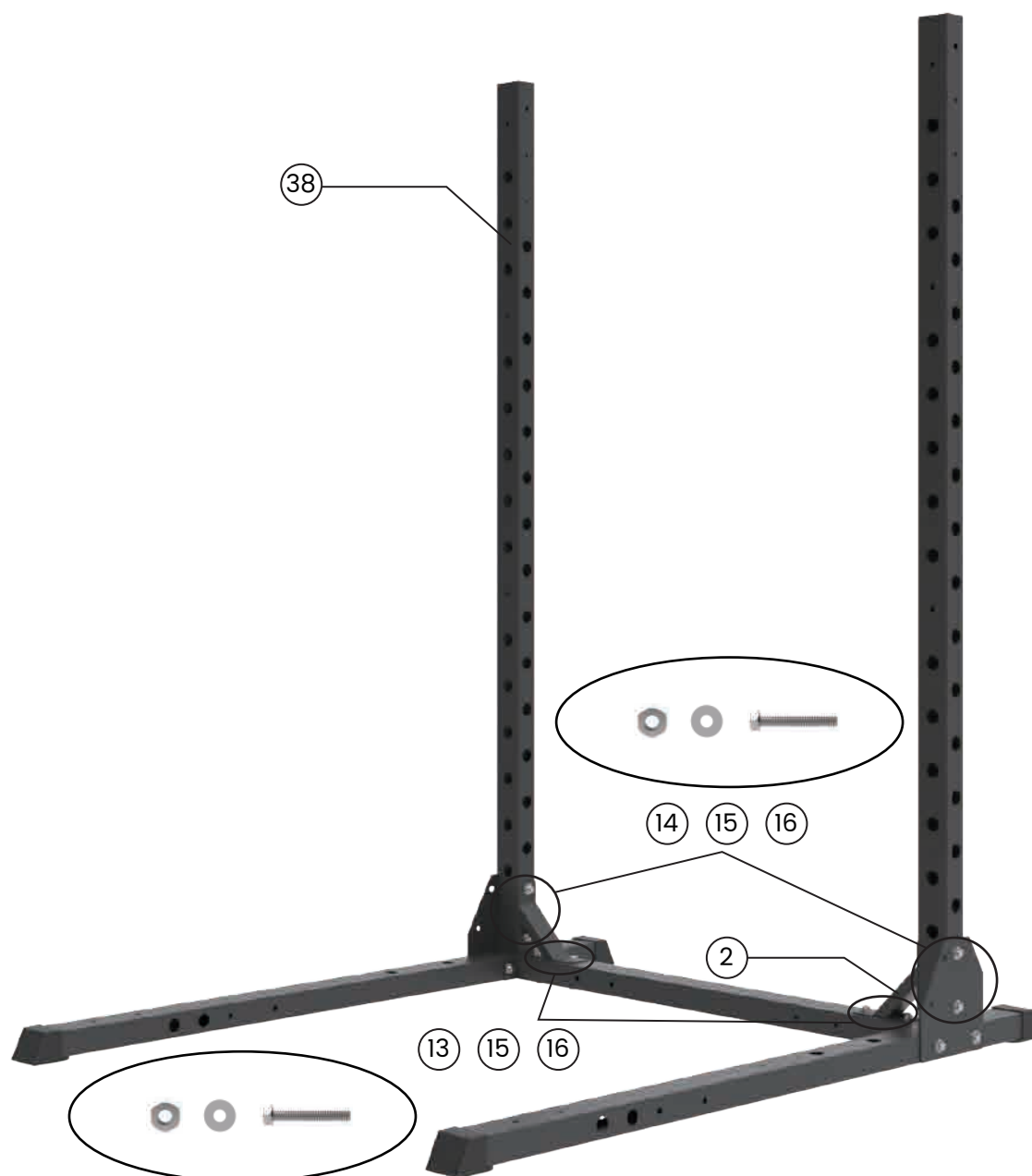

ASSEMBLY AND ANJUSTMENT

STEP 3

NO.	DESCRIPTION.	QYANTITY
5	Bottom Fixed Plate	4
14	M10*90 Hex Bolt	10
15	Nut	10
16	Washer	20
17	Cable Pulley	2
18	Pulley Sliding Sleeve	2
32	Pulley	2
41	Upright Frame	2



ASSEMBLY AND ANJUSTMENT

STEP 4

NO.	DESCRIPTION.	QYANTITY
13	M10*70 Hex Bolt	4
15	Nut	4
16	Washer	8
45	Upper Cross Frame	2
47	Upper Connect Rod	2



ASSEMBLY AND ANJUSTMENT

STEP 5

NO.	DESCRIPTION.	QYANTITY
13	M10*70 Hex Bolt	4
15	Nut	4
16	Washer	8
19	Guide Fixed Frame	2
27	Shock Pad	4
28	Guide Rod	4
30	Weight Plate Frame	2
43	Weight Plate Rod	4

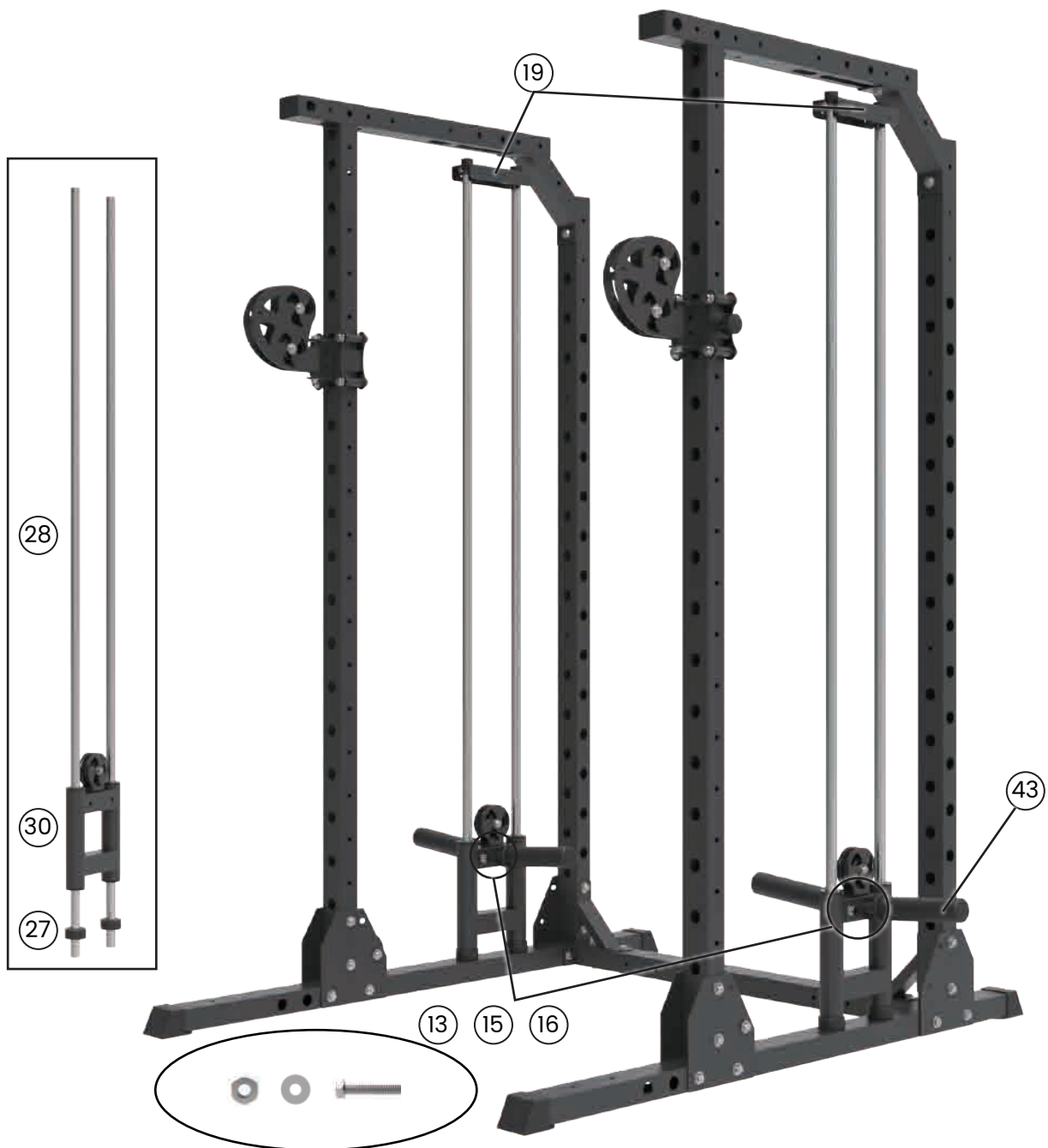

ASSEMBLY AND ANJUSTMENT

STEP 6

NO.	DESCRIPTION.	QYANTITY
8	Connect Plate	4
10	M8*20 Hex Bolt	8
14	M10*90 Hex Bolt	10
15	Nut	10
16	Washer	20
23	Logo Board L	2
24	Logo Board R	2
32	Pulley	4
39	Small Pulley	2

Please install this screw
after installing the cable.

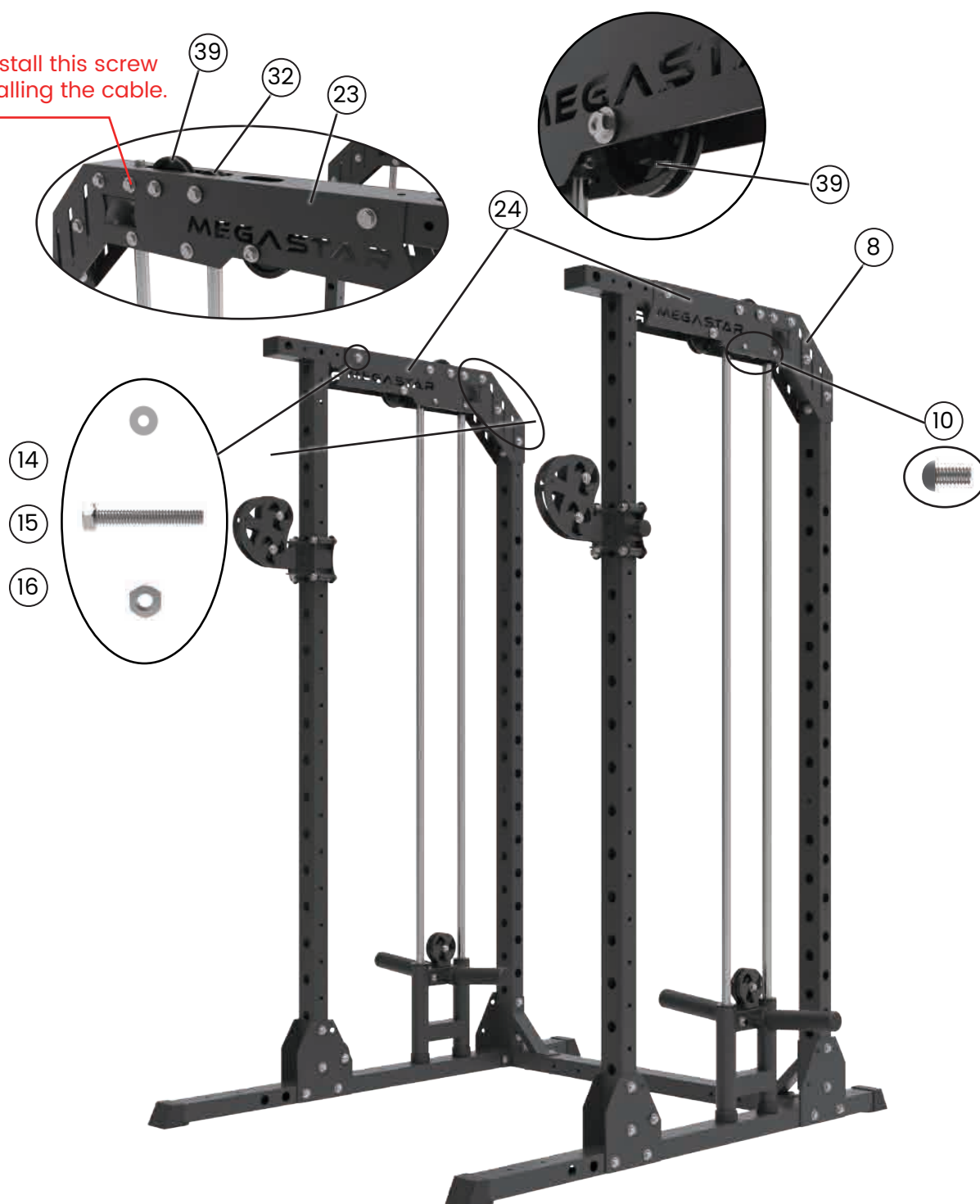

ASSEMBLY AND ANJUSTMENT

STEP 7

NO.	DESCRIPTION.	QYANTITY
14	10*90 Hex Bolt	4
15	Nut	4
16	Washer	8
32	Pulley	2
33	Pull-Up Bar	1
48	Top Fixed Plate	2



ASSEMBLY AND ANJUSTMENT

STEP 8

NO.	DESCRIPTION.	QYANTITY
9	M5*10 Hex Bolt	8
14	M10*90 Hex Bolt	4
15	Nut	4
16	Washer	8
26	Rear Logo Connect	2
34	Rear Cross Beam	1
37	Rear Logo	1



ASSEMBLY AND ANJUSTMENT

STEP 9

NO.	DESCRIPTION.	QYANTITY
6	Barbell Hold	2
14	M10*90 Hex Bolt	4
15	Nut	4
16	Washer	8
42	Weight Plate Holder	4



ASSEMBLY AND ANJUSTMENT

STEP 10

NO.	DESCRIPTION.	QYANTITY
4	Band Peg	6
7	Big Foot Pedal	1
11	M10*20 Hex Bolt	4
21	Landmine	1
46	Plug	6



ASSEMBLY AND ANJUSTMENT

STEP 11

NO.	DESCRIPTION.	QYANTITY
29	Dip Bar	2
35	Sandwich J Cup	2
36	Safety Arm	2



ASSEMBLY AND ANJUSTMENT

STEP 12

NO.	DESCRIPTION.	QYANTITY
11	10*20 Hex Bolt	2
15	Nut	2
16	Washer	4
20	Handle	2
25	Cable	2
44	Carabiner	2



ASSEMBLY AND ANJUSTMENT

